

BBS/FHL

HIGH PRESSURE-BALL VALVE WITH FLANGES

DN 40-50 | PN 100-315

FULL BORE

MATERIALS

MATERIALS	PN	DN	Type 1	Type 2
Body	100-315	40-50	Steel	Steel
Ball	100-315	40-50	Steel, hard chromed	Steel, hard chromed
Sealings	100-160 250-315	40-50	Polyamid Delrin	PTFE -

INFORMATION

Ball Valve with flanges

/// Length face-to-face DIN EN 558 FTF 1

/// Flange dimensions DIN 2501 Blatt 1

/// The lever is included

OPTIONS

/// Other shapes of flange sealing surfaces on request

/// Special designs on request

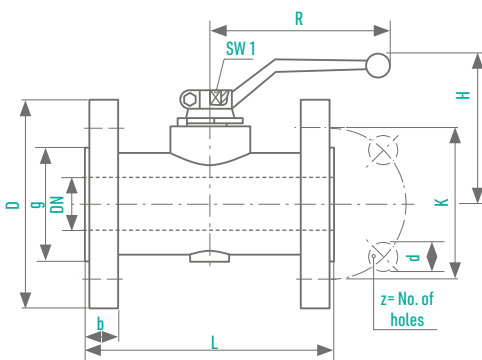

	PN		L [mm]	D [mm]	g [mm]	K [mm]	b [mm]	z [mm]	d [mm]	H [mm]	R [mm]	SW1 [mm]	Weight [kg]	Order-Number	
	DN [mm]	Polyamid, Delrin PTFE												Type 1	Typ2
PN 100-160 Raised face	40	100	200	170	88	125	28	4	22	135	325	16	12,8	0131004	0131011
	50	100	230	195	102	145	30	4	26	145	325	16	19,1	0131005	0131012
PN 250 Raised face	40	-	200	185	88	135	34	4	26	155	325	16	16,8	0131006	/
	50	-	230	200	102	150	38	8	26	160	325	16	22,4	0131007	/
PN 315 Raised face	40	-	200	195	88	145	38	4	26	155	325	16	20,4	0139890	/
	50	-	230	210	102	160	42	8	26	160	325	16	25,8	0139891	/

* Weight refers to type 1. Weight of type 2 may differ.