

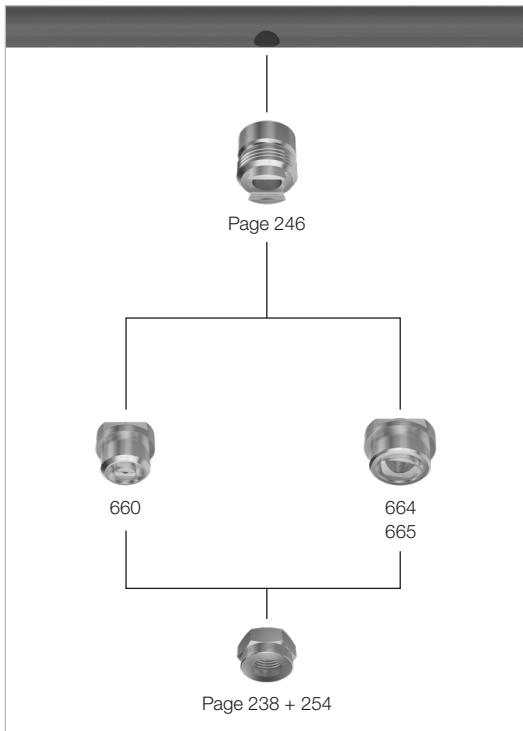

### Assembly accessories for nozzles with dovetail version

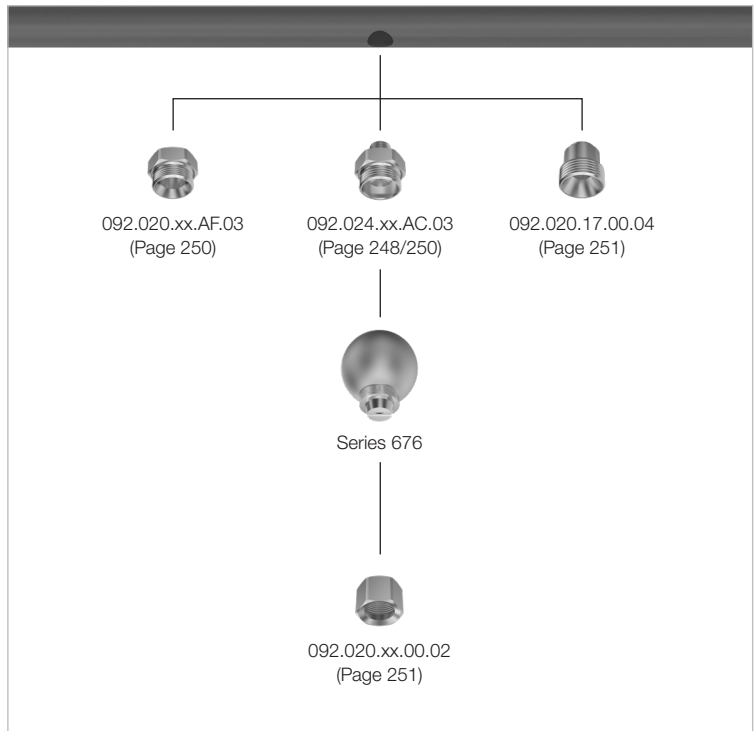

### Assembly accessories for nozzles with integrated ball joint



### TWISTLOC quick-release system for nozzles without thread

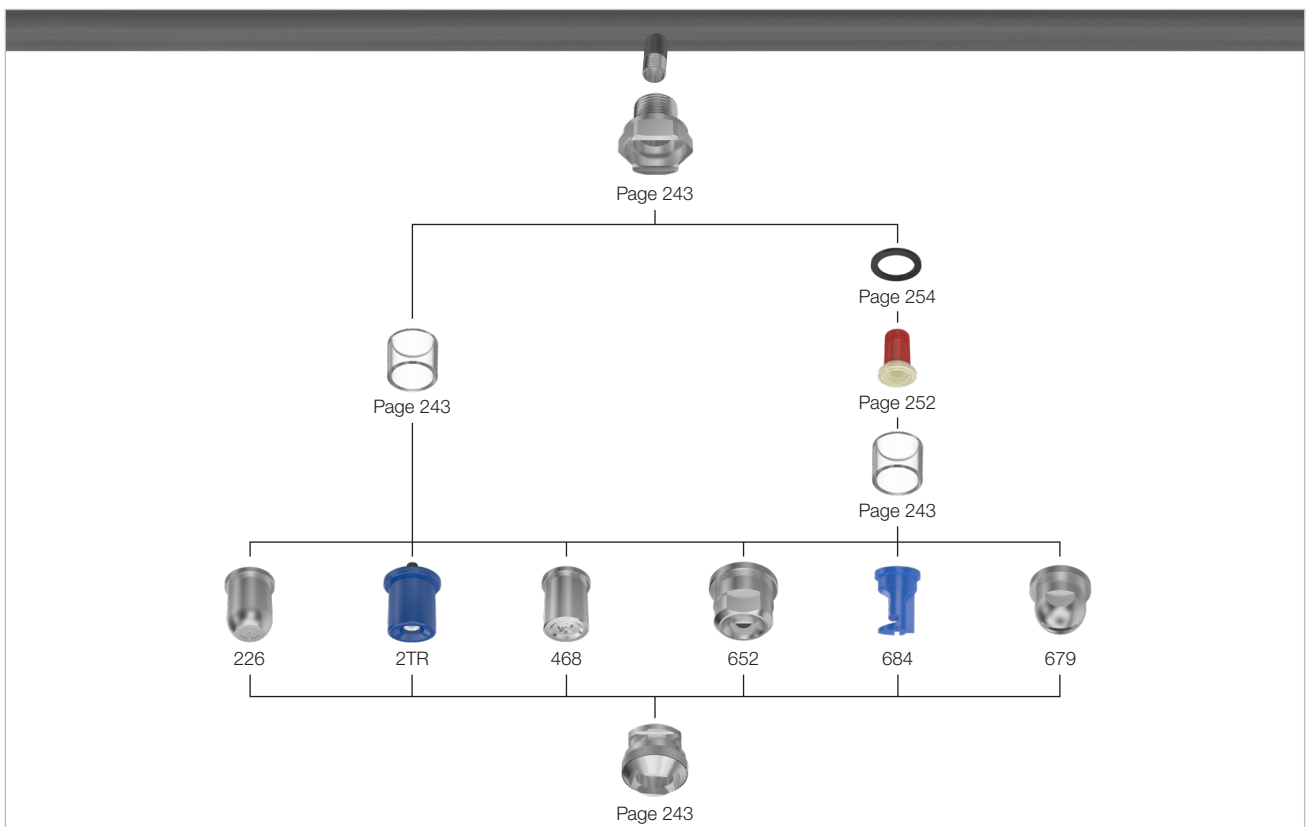

# Accessories for nozzle series 676 with integrated ball joint



## Threaded sockets

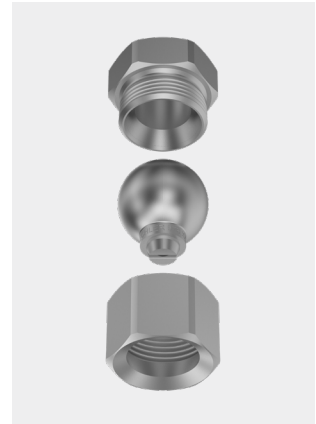
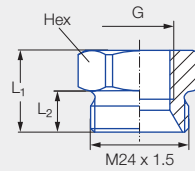
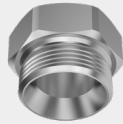

Series	Ordering no.		G BSPP	Dimensions [mm]			Weight [g] (Brass)	
	Type	Mat. no.		L <sub>1</sub>	L <sub>2</sub>	Hex		
		16						30
		Stainless steel 303	Brass					
676	092.020.xx.AF.03 <sup>1</sup>	●	●	3/8	20.0	10.0	27	50.0

<sup>1</sup> Replace "xx" by material no.

## Threaded nipple

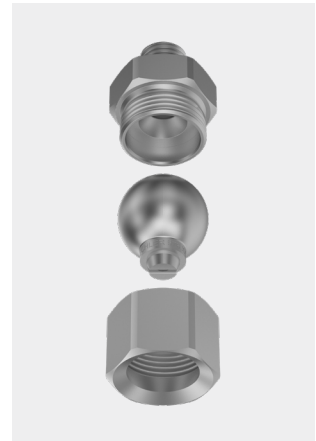
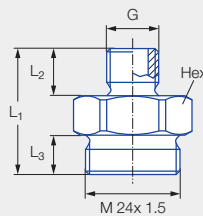

Series	Ordering no.		G BSPP	Dimensions [mm]			Weight [g] (Brass)		
	Type	Mat. no.		L <sub>1</sub>	L <sub>2</sub>	L <sub>3</sub>			
		16						30	
		Stainless steel 303	Brass						
676	092.024.xx.AC.03 <sup>1</sup>	●	●	1/4	32.0	12.0	10.0	27	70.0

<sup>1</sup> Replace "xx" by material no.

Order    Type            +    Material no.    =    Ordering no.  
example: 092.020.xx.AF.03    +    16                    =    092.020.16.AF.03

### Welded nipple

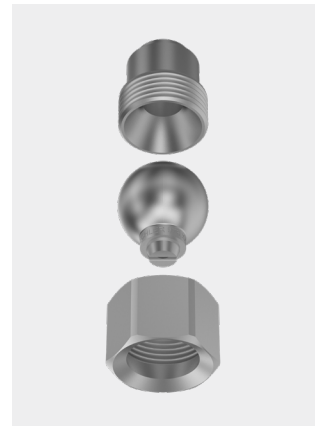
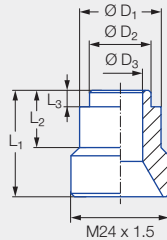

Series	Ordering no.		Dimensions [mm]						Weight [g]
	Type	Mat. no.	L <sub>1</sub>	L <sub>2</sub>	L <sub>3</sub>	Ø D <sub>1</sub>	Ø D <sub>2</sub>	Ø D <sub>3</sub>	
		17							
		Stainless steel 316Ti							
676	092.020.17.00.04	●	26.0	14.0	4.0	20.0	15.0	11.0	45.0

### Retaining nuts

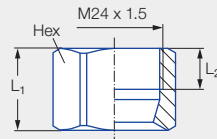
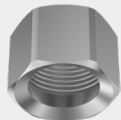

Series	Ordering no.		Dimensions [mm]				Weight [g] (Brass)
	Type	Mat. no.		L <sub>1</sub>	L <sub>2</sub>	Hex	
		16	30				
		Stainless steel 303	Brass				
676	092.020.xx.00.02 <sup>1</sup>	●	●	20.0	10.0	27	35.0

<sup>1</sup> Replace "xx" by material no.

**Notice:** The assembly accessories shown can be used with the low pressure flat fan nozzle with ball joint (series 676) (see Page 140/252).

Order Type + Material no. = Ordering no.  
 example: 092.020.xx.00.02 + 16 = 092.020.16.00.02